

LEUCHTEN-SYSTEM 710 mit KLARGLASOPTIK \* LIGHTING SYSTEM 710 with CLEAR OPTICS

Einzelfunktionsleuchten (Ausnahme Brems-Schlussleuchte) mit montierten Glühlampen, anschlussfertig. Die Leuchten sind mittels einem in verschiedenen Farben lieferbaren Zierring auf einen Durchmesser von 122 mm vergrößerbar. Die Leuchten der Serie 710 werden mit abgewinkeltem Zentralstecker geliefert. Weitere Ausführungen, Blinkleuchte vorne mit gelber Glühlampe und weisser Lichtscheibe, Begrenzungsleuchte und Leuchten in 24 V bitte anfragen. Glühlampe: P 21 W (BRS 710 P 21/ 5 W).  
 Single Function Lights (except Stop / Tail Light) bulbs fitted, ready for plug-in. The lights of series 710 can be extended by a decoration rim to a diameter of 122 mm. They are available with a angular central lock connector. Further models, Front Direction Indicator Light, Front Direction Indicator Light with yellow bulb and white lens, Front Marker Light and models in 24 V on request. Bulb: P 21 W ( BRS 710 P 21/ 5 W).











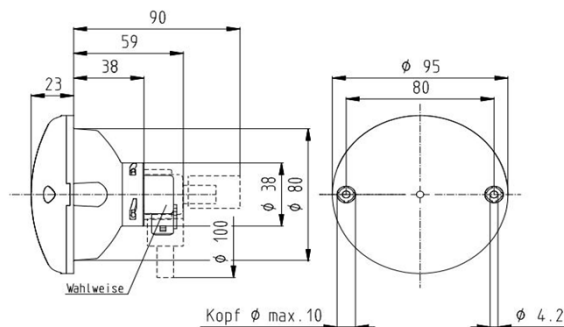

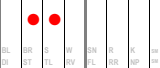
Bild Picture	Art.-Nr. / No. Typ / Type	Beschreibung Description	Merkmale Features	Spann. Voltage	Leistung Power	Material / Farbe Material / Colour	Anschluss Connection	Gewicht Weight	IP / Temp.	VP PU	Homolog. Approval
	<b>10.0005.500</b> BRS 710-W	Brems-Schlussleuchte <i>Stop / Tail Light</i>		12 V	P 21 / 5 W	PC / ABS rot - red	Winkel-GL-Halter <i>angular connectors</i>	0,08 kg		75 E/16	E1-1542
	<b>13.1019.500</b> BL 710	Blinkleuchte / Kat. 2a <i>DI / Cat. 2a</i>		12 V	P 21 W	PC / ABS gelb - yellow	Winkel-GL-Halter <i>angular connectors</i>	0,08 kg		75 E/16	E1-1547
	<b>13.1031.500</b> BL 710/2a	Blinkleuchte / Kat. 2a <i>DI / Cat. 2a</i>		12 V	PY 21 W	PC / ABS klar - clear	Winkel-GL-Halter <i>angular connectors</i>	0,08 kg		75 E/16	E1-1547
	<b>13.3016.500</b> SN 710-W	Nebelschlussleuchte <i>Fog Light</i>		12 V	P 21 W	PC / ABS rot - red	Winkel-GL-Halter <i>angular connectors</i>	0,08 kg		75 E/16	E1-1543
	<b>13.6011.500</b> W 710-W	Rückfahrleuchte <i>Reversing Light</i>		12 V	P 21 W	PC / ABS klar - clear	Winkel-GL-Halter <i>angular connectors</i>	0,08 kg		75 E/16	E1-1544

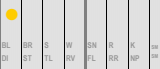

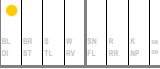
Zubehör / Ersatzteile \* Accessories / Spare parts

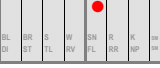

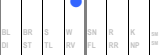
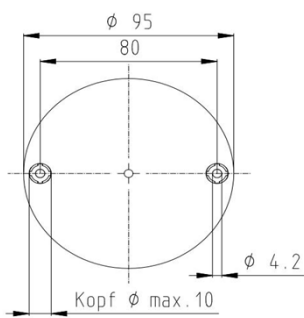
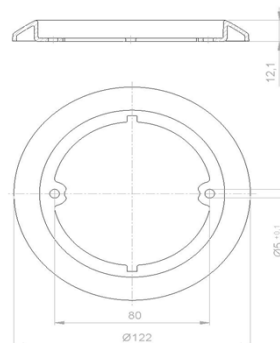
R 710



19.2016.

	<b>30.0016.000</b> R 710	Rückstrahler <i>Reflex Reflector</i>	klarglasoptik <i>clear optics</i>			PMMA / SAN rot - red		0,06 kg		100 E/26	
	<b>19.2016.000</b>	Deko-Ring <i>Decoration Rim</i>	versp./ hochglanz <i>chrome</i>			SAN chrom - chrome		0,02 kg		50 E/30	
	<b>19.2016.100</b>	Deko-Ring <i>Decoration Rim</i>	versp./ hochglanz <i>chrome</i>			SAN rot - red		0,02 kg		50 E/30	

	<b>19.2016.200</b>	Deko-Ring <i>Decoration Rim</i>	versp./ hochglanz <i>chrome</i>			SAN gelb - <i>yellow</i>		0,02 kg		50 E/ 30
--	--------------------	------------------------------------	------------------------------------	--	--	-----------------------------	--	---------	--	-------------

Zusatz-Information:  
*Additional Information:* Deko-Ringe für Leuchten-Systeme 710 / 720 / 725  
*Decoration Rims for Lighting Systems 710 / 720 / 725*

	<b>53.5004.011</b>	Adapter Kabel / links <i>Adapter Cable / LH</i>	2 polig / 300 mm <i>2 pins / 300 mm</i>					0,02 kg		50
--	--------------------	--	--	--	--	--	--	---------	--	----

	<b>53.5004.021</b>	Adpter Kabel / rechts <i>Adapter Cable / RH</i>	2 polig / 300 mm <i>2 pins / 300 mm</i>					0,02 kg		50
--	--------------------	--	--	--	--	--	--	---------	--	----

	<b>53.5004.031</b>	Adapter Kabel / links <i>Adapter Cable / LH</i>	3 polig / 300 mm <i>3 pins / 300 mm</i>					0,03 kg		50
--	--------------------	--	--	--	--	--	--	---------	--	----

	<b>53.5004.041</b>	Adpter Kabel / rechts <i>Adapter Cable / RH</i>	3 polig / 300 mm <i>3 pins / 300 mm</i>					0,03 kg		50
--	--------------------	--	--	--	--	--	--	---------	--	----

<b>E</b>	in Einzelverpackung erhältlich! <i>available in individual packaging!</i>	> Artl.-No./CODE - XX.XXXX.XXX <b>E</b>	<b>E/xxx</b>	Einzelverpackungen auch im Sammelkarton mit xxx Stück erhältlich! <i>individual packaging available in a collective box with xxx pieces!</i>
----------	--	---	--------------	---